

RECOMMENDED  
INSTALLATION  
TOOLING

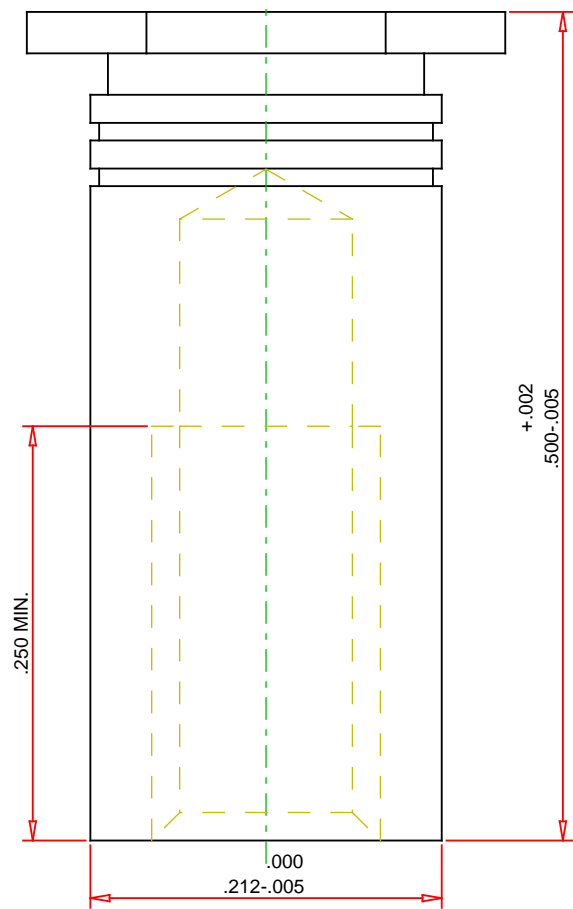
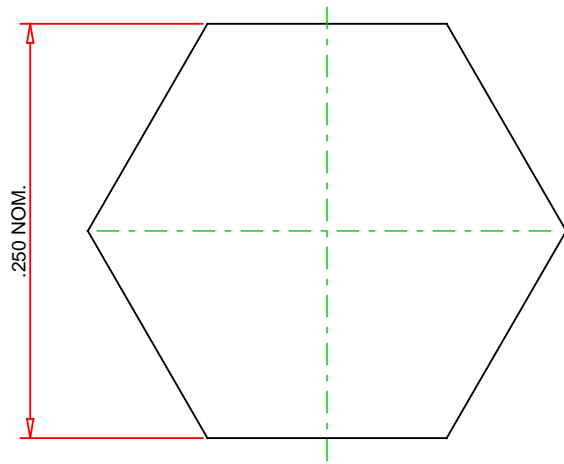
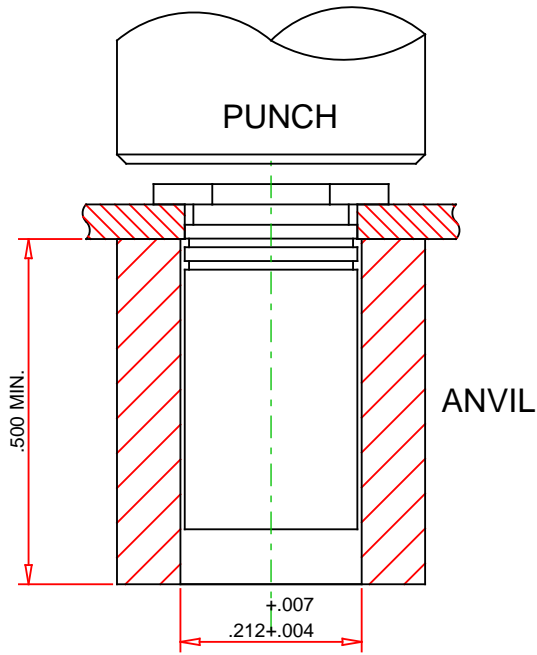

© 2019 PennEngineering

ALL DIMENSIONS IN INCHES

DATE 3-DEC-2019

NOTE : DRAWING NOT TO SCALE

THREAD : .138-32 (#6-32)

MOUNTING HOLE DIA. :  $.213^{+.003}_{-.000}$

MATERIAL: STEEL

PANEL THICKNESS: .040 MINIMUM

HEAT TREAT: YES

MAX. PANEL HARDNESS: HRB 80 / HB 150

FINISH: ZINC PLATED PER ASTM B633, SC1 (5µm),  
TYPE III, COLORLESS

MIN CENTERLINE-TO-EDGE: 0.27

DESCRIPTION :

BLIND THREADED STANDOFFS - TYPES BSO, BSOA, BSOS -  
UNIFIED



PennEngineering®

PART NO. :

BSO-632-16ZI

EMAIL: TECHSUPPORT@PEMNET.COM  
WWW.PEMNET.COM