

RECOMMENDED  
INSTALLATION  
TOOLING

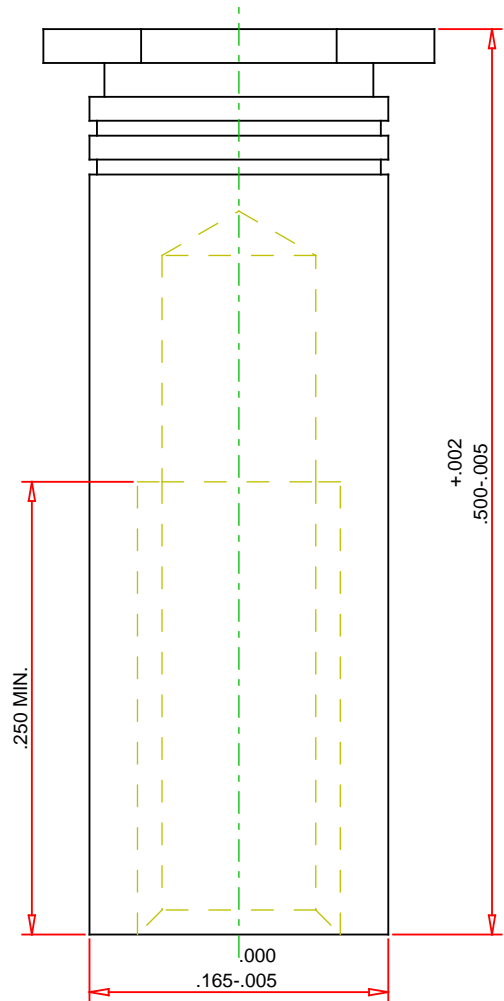
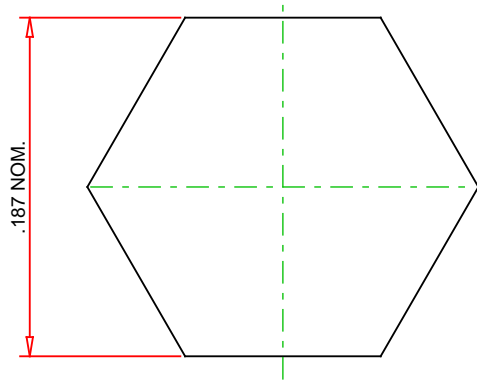
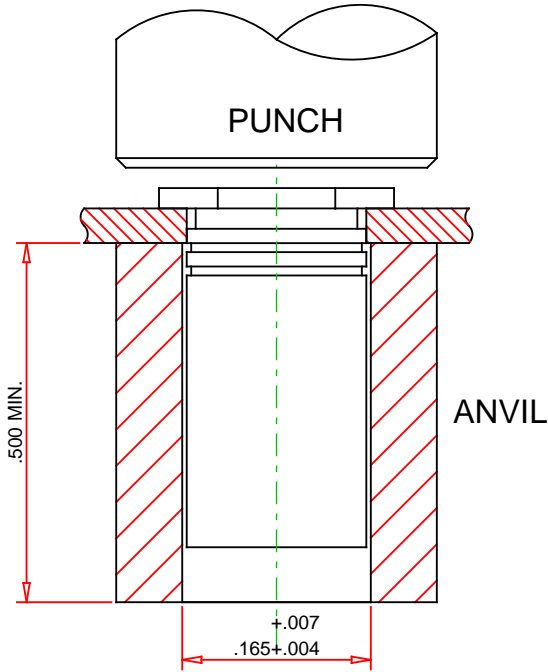

© 2019 PennEngineering

ALL DIMENSIONS IN INCHES

DATE 3-DEC-2019

NOTE : DRAWING NOT TO SCALE

THREAD : .112-40 (#4-40)	MOUNTING HOLE DIA. : .166 +.003 -.000
MATERIAL: 300 SERIES STAINLESS STEEL	PANEL THICKNESS: .040 MINIMUM
HEAT TREAT: NONE	MAX. PANEL HARDNESS: HRB 70 / HB 125
FINISH: Passivated and/or tested per ASTM A380	MIN CENTERLINE-TO-EDGE: 0.23

DESCRIPTION :  
BLIND THREADED STANDOFFS - TYPES BSO, BSOA, BSOS -  
UNIFIED

PART NO. :  
BSOS-440-16



PennEngineering®

EMAIL: TECHSUPPORT@PEMNET.COM  
WWW.PEMNET.COM